

SYSTEM

YONOS

NOMENCLATURE

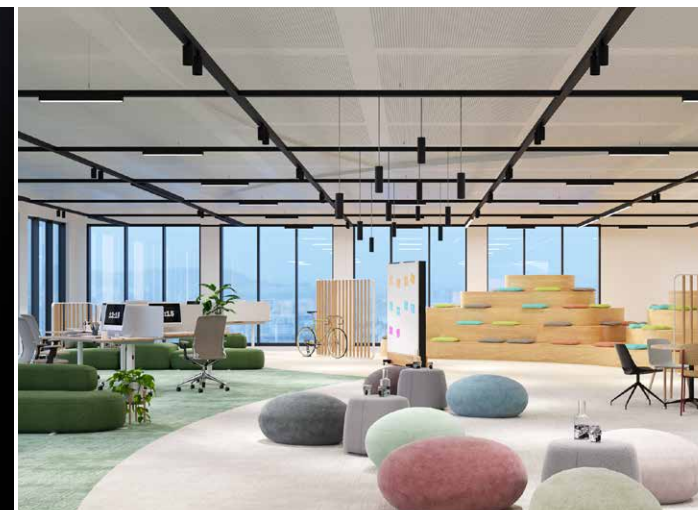

BASE ELEMENT

Product name	Base element	Installation method	Length	Wiring	Tap distances	Indirect optics	Luminous flux per length	Colour rendering and colour temperature	Switching type
YNS YONOS	BE Base element	D Surface-mounted H Suspended	65 650 mm, single & continuous line 130 1300 mm, single & continuous line 162 1625 mm, single luminaire 195 1952 mm, continuous line 260 2600 mm, continuous line	5LV 5-pole 7LV 7-pole	32 325 mm 65 650 mm	LIUW Lens - Indirect Ultra Wide YY No indirect component	3 - 140 300 - 14,000 lm	830 3,000 K, CRI80 840 4,000 K, CRI80 930 3,000 K, CRI90 940 4,000 K, CRI90 8TW 2,700 - 6,500 K, CRI80 9TW 2,700 - 6,500 K, CRI90	DD DALI dimmable

Example configuration: YNS BE H 130 5LV-32 LIUW 3-8TW DD

YNS	BE	H	130	5LV	-	32	LIUW	3	-	8TW	DD
-----	----	---	-----	-----	---	----	------	---	---	-----	----

LUMINAIRE INSERT

Product name	Installation method	Width	Length	Optics Direct	Light chamber colour (only with ConVision)	Direct luminous flux (per luminaire insert length)	Colour rendering and colour temperature	Switching type	Housing colour
YNS YONOS	DH Surface-mounted/suspended	7 67 mm 22 220 mm 31 312 mm	32 325 mm 65 650 mm 130 1300 mm 162 1625 mm	CLW19 Convision - Wide [19] CLW16 Convision - Wide [16] CLWW Convision - Wall Washer PW19 Prismatic - Wide [19] PHW22 Prismatic Height - Wide [22] DW19 Diffuser - Wide [19] PN19 Prismatic - Narrow [19] PWW Prismatic - Wall Washer PW22 Prismatic - Wide [22] DL22 Diffuser - Lambertian [22]	01 white 03 silver 05 black	10 - 60 1,000 - 6,000 lm	830 3,000 K, CRI80 840 4,000 K, CRI80 930 3,000 K, CRI90 940 4,000 K, CRI90 8TW 2,700 - 6,500 K, CRI80 9TW 2,700 - 6,500 K, CRI90	DD DALI dimmable RF Radio	01 white 03 silver 05 black

Example configuration: YNS DH22x130 CLW19-03 10-8TW DD 03

YNS	DH	22	x	130	CLW19	-	03	10	-	8TW	DD	03
-----	----	----	---	-----	-------	---	----	----	---	-----	----	----